



Sling Model:

Serial Number:

User Name:

*The sling model and serial number
are located on the label on the reverse of the sling.*

THIS USER GUIDE IS APPLICABLE
FOR THE FOLLOWING
COMFORT VALUE® TRANSPORT:

CVTR: COMFORT VALUE® Transport

Care & Independence Ltd is a UK manufacturer registered with MHRA as a Class 1 Medical Device Manufacturer and this is a Class 1 medical device as defined in Article 51, Annex VIII Rule 1 of the Medical Device Regulation 2017/745.

These devices are designed and manufactured to meet or exceed BS EN 10535:2021 for the transfer of disabled persons and are designed and manufactured by Care & Independence, a certified ISO9001:2015 organisation.

Declaration

Care & Independence Ltd, declares under its sole responsibility that the aforementioned products to which this declaration relates, and which bear the CE marking, are in conformity with the applicable requirements of EU regulation 2017/745 as transposed in the laws of the Member States.

Intended Purpose

The device is intended to be used with hoisting equipment to allow a care giver, or the individual needing assistance, to reposition a person, to a different standing, or sitting position, to allow numerous activities to be completed.

ISSUE DATE: 15/03/24
VERSION: UG/CVTR-EN04
STATUS: APPROVED
AUTHORISED BY: Technical Director

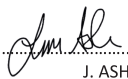
.....
J. ASH



1. GENERAL



1.1 WARRANTY: The COMFORT VALUE® slings covered in this User Guide have been awarded a THREE YEAR WARRANTY. Any manufacturing defect will be rectified free of charge. Product damage through wear and tear, neglect or accidental damage is not covered by the warranty.

1.2. COMPATIBILITY: Care & Independence slings have been manufactured to work with most of the major hoist manufacturers' equipment. A compatibility statement is available on request.

2. SLING SAFETY



2.1 GENERAL:

2.1.1. Only competent persons should ever use hoists and slings.

2.1.2 A risk assessment must be completed before using the sling, even if the hoist and sling is provided from the same manufacturer.

2.1.3 It is essential that the sling is fit for purpose; the correct size and type of sling for an individual is essential to ensure the safety and comfort of the person being transferred.

2.1.4 Product care and inspection instructions should be followed at all times.

2.1.5. **No sling must ever be used to lift more than its rated load** (see label).

2.1.6. The intended sling and hoist combination should be compatible.

2.1.7 **If there is any doubt about sling safety, remove the sling from use until checked and authorised for use by a competent person.**

2.2 SLING INSPECTION:

2.2.1 Care & Independence recommend pre-use sling checks by competent person.

2.2.2 Slings are Class One Medical Devices and are subject to Lifting Operations and Lifting Equipment Regulations (LOLER) Examinations. A LOLER examination may only be conducted by a person trained and qualified to do so. Space is provided on the sling label to record LOLER details.



3. DAMAGED OR FAULTY SLINGS



Care & Independence have a strict *Returns & Repair Procedure* to ensure the safety of all involved.

Please **do not** send slings and bathing products back without completing the Return/Repair form.

4. PRODUCT CARE



4.1 GENERAL CARE:

4.1.1 Repeated washing may lead to sling deterioration. **Care & Independence strongly recommend replacing the sling at the first signs of wear or damage, as opposed to after a specified time frame.**

4.1.2 Each sling is marked with its maximum wash temperature.

4.1.3 Discolouration to some materials or fading labels may occur as a result of laundering. **NOTE: It is a health & safety requirement that the sling label must be legible throughout the sling's working lifetime.**

4.2 WASHING THE SLING: Every sling is marked with its maximum wash temperature. Close hook & loop fastenings before laundering to prevent damage to the fabric and webbing.

4.3 DECONTAMINATION:

Slings can withstand a strong decontamination routine but regular use may impair the lifespan of the sling.

A copy of these instructions should be provided to the person(s) laundering the sling.



- Wash gently at 40°C. Use a mild soap solution or a non-biological detergent without bleaching additives.
- Do not add bleach or stain removers.
- Air dry, cabinet dry or tumble dry on a cool cycle (below 60°C). Do not tumble dry on a hot setting.
- Do not place on hot pipes or heaters. Keep away from flames.
- Do not iron.

FURTHER INFORMATION: Available to download from our website



- Sling Care Instruction Guide (includes decontamination advice).
- Returns & Repair Procedure

5. GETTING TO KNOW YOUR SLING

5.1 THE TRANSPORT STYLE SLING

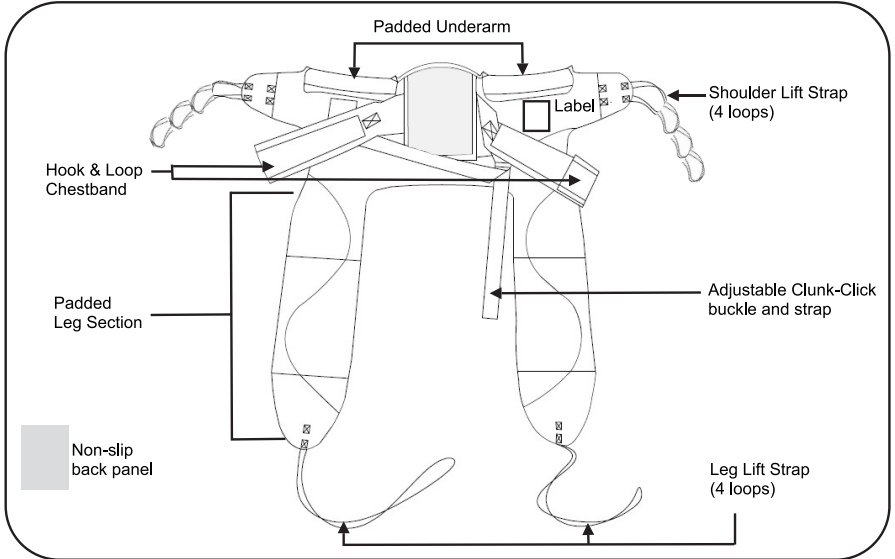

5.2 SLING LABELS EXPLAINED

Each COMFORT VALUE® sling has one printed label sewn onto the back.

The label contains useful information such as Sling Model Type, Size, and Serial number. Safety information and washing instructions are included too. There is also a section where LOLER checks can be recorded as well as space to write the User's name.

Further product information can be obtained by scanning the QR code that leads direct to the product webpage where support resources are available such as full product information, user guides, fitting videos and more besides.

QR CODE: LEADS TO PRODUCT INFORMATION AND USER GUIDES		CARE & INDEPENDENCE CONTACT INFO	
SLING INFORMATION YEAR OF MANUFACTURE MODEL SIZE PRODUCT CODE SERIAL NUMBER		LOLER RECORD INPUT	
BAR CODES			
SAFETY INFO			
RECOMMENDED CARE INSTRUCTIONS		SWL IN KG	
QUALITY MARKS & INFO			
NAME: _____			



6. FROM A SEATED POSITION ONLY

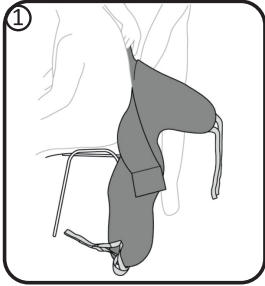

6.1.1

Slide the sling down the User's back so the bottom of the sling is level with the sacrum.

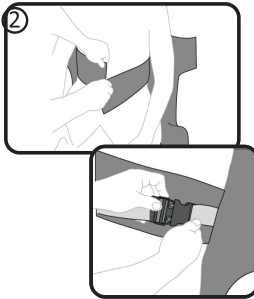

6.1.2

- i. Wrap the chest band around the torso and fasten the hook & loop attachment.
- ii. Fasten the buckle ensuring a 2-finger width between the chestband and torso for comfort. There will be an audible click when buckle is secured.
- iii. Perform a 'tug test'*.

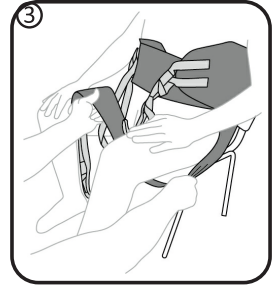

6.1.3

- i. Slide the leg section under the thigh.
- ii. Repeat on other thigh.

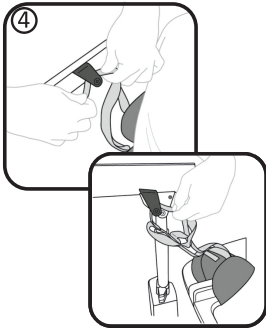

6.1.4

- i. Move stand aid into position ensuring appropriately and individually adjusted for the User.
- ii. On both sides, attach the appropriate shoulder loop strap to the standing aid lifting horn.
- iii. Attach the appropriate leg loop straps to both sides of the mast.

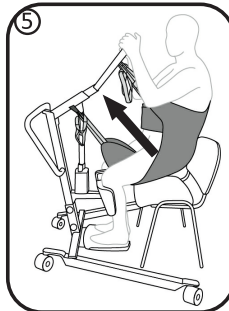

6.1.5

- i. Perform a 'tug test'* then check for snagging
- ii. Raise into a semi-standing position to complete the transfer.



*A manual 'Tug Test' is recommended to ensure buckles and/or straps are properly secured prior to hoisting. For buckles, tug straps in opposite directions. For spreader bar attachment, tug straps in a downward motion.



7. ADDITIONAL SUPPORT



SCAN SLING LABEL QR CODE FOR;

- Product information
- User Guide
- Fitting video
- Sling Care Instruction Guide
- Sling Pre-Check Inspection Guide
- Sling Sizing Guide



Free product training is also offered. Please contact us for further information.



- Expert advice
- Full support



- Faded label replacement
- Sling repair
- LOLER examinations

This space has been intentionally blank

Comfort VALUE[®] USER GUIDE



Care & Independence Ltd,
Unit 3, Telford Business Centre,
Telford Road, Bicester, OX26 4LD

033 012 80808

sales@careandindependence.com

Monday - Friday 08.30 -17.00

If a third party supplier has provided the COMFORT VALUE[®] sling, you may like to write their contact details here:

