



**Bathing Model:**.....

**Serial Number:** .....

**User Name:** .....

*The bathing model and serial number  
are located on the label on the frame.*

THIS USER GUIDE IS APPLICABLE  
FOR THE FOLLOWING  
**BATHING PRODUCTS ONLY:**

981-S: Tilt-In-Space Chair - Adult  
981-S/P: Tilt-In-Space Chair - Paediatric  
981-S/IN: Tilt-In-Space Chair - Infant

900-S: Tilt-In-Space Cradle - Adult  
900-S/P: Tilt-In-Space Cradle - Paediatric  
900-S/IN: Tilt-In-Space Cradle - Infant

Please ensure that both the  
product and any associated  
accessories have been  
adjusted by a competent  
person prior to its initial use.

ISSUE DATE: 15/03/24  
VERSION: UG/BR-TISFAM-EN04  
STATUS: APPROVED  
AUTHORISED BY: Technical Director

  
.....  
J. ASH



improving lives



Thank you for choosing a Care & Independence BATHING RANGE product.

We trust both you and the end-user will find the product easy and comfortable to use throughout its lifetime.

In the event that you are dissatisfied with product performance or have any queries relating to the product usage that are not addressed in this User Guide, please contact Care & Independence.

Care & Independence Ltd is a UK manufacturer registered with MHRA as a Class 1 Medical Device Manufacturer and this is a Class 1 medical device as defined in the Medical Device Regulation 2017/745.

Our devices are designed and manufactured to meet or exceed BS EN 10535:2021 for the transfer of disabled persons and are designed and manufactured by Care & Independence, a certified ISO9001:2015 organisation.

#### Declaration

Care & Independence Ltd, declares under its sole responsibility that the aforementioned products to which this declaration relates, and which bear the CE marking, are in conformity with the applicable requirements of EU regulation 2017/745 as transposed in the laws of the Member States.

#### Intended Purpose

The device is intended for use by a care giver as a mobility aid for less-abled persons when assisted-bathing needs are required.

# Bathing Range

## USER GUIDE

### CONTENTS

<b>1. General</b> .....	Page 3
- Warranty	
<b>2. Bathing Product Safety</b> .....	Page 3
- General	
- Equipment Inspection	
- Equipment Servicing	
<b>3. Damaged or Faulty Product</b> .....	Page 3
<b>4. Product Care</b> .....	Page 3
- General	
- Cleaning	
- Decontamination	
<b>5. Getting to Know Your Product</b> .....	Page 4
- Tilt-In-Space Chair and Cradle	
- Product Labels Explained	
<b>6. Operational Instruction</b>	
- Headrest .....	Page 5
- Backrest .....	Page 5
- Armrests .....	Page 6
- Seating .....	Page 6-7
- Calf Rest .....	Page 7
- Footrest .....	Page 7
- Brakes .....	Page 8
- Tilt Recline .....	Page 8
<b>7. Additional Support</b> .....	Page 8

## 1. GENERAL



### WARRANTY:

The BATHING RANGE products covered in this User Guide have been awarded a FIFTEEN YEAR WARRANTY on frame and TWO YEAR on components. Any manufacturing defect will be rectified free of charge. Product damage through wear and tear, neglect or accidental damage is not covered by the warranty.

## 2. BATHING PRODUCT SAFETY



### 2.1 GENERAL:

- 2.1.1. Only competent persons should ever use bathing equipment.
- 2.1.2 A risk assessment must be completed before using the product.
- 2.1.3 It is essential that the equipment is fit for purpose; the correct size and type of product for an individual is essential to ensure the safety and comfort of the user.
- 2.1.4 Product care and inspection instructions should be followed at all times.
- 2.1.5. **No bathing equipment must ever be used for more than its rated load** (see label).
- 2.1.6 We advise that vulnerable users are not left unattended when using this equipment.
- 2.1.6 **If there is any doubt about equipment safety, remove the equipment from use until checked and authorised for use by a competent person.**
- 2.1.7 For all associated bathing accessories supplied with this product, please ensure these items have been adjusted accordingly by a competent and trained person authorised to do so. Failure to do so may minimise support, comfort and could result in injury. please refer to the specific user guide instructions. If you require further information please contact Care & Independence.



### 2.2 EQUIPMENT INSPECTION:

Care & Independence recommend pre-use equipment checks by a competent person to ensure the equipment is free from defects.



### 2.3 EQUIPMENT SERVICING:

An annual servicing of the equipment is recommended.

## 3. DAMAGED OR FAULTY PRODUCT



Care & Independence have a strict *Returns & Repair Procedure* to ensure the safety of all involved.

Please **do not** send products back without completing the **Return/Repair form**.

## 4. PRODUCT CARE



### 4.1 GENERAL CARE:

Discolouration to some materials or fading labels may occur as a result of use over time.

NOTE: It is a recommended that the product label remain legible throughout the product's working lifetime but is not currently a statutory requirement.



### 4.2 CLEANING THE EQUIPMENT:

- After use, the product should be cleaned with particular attention being paid to the equipment bed base area.
- It is recommended to use clean warm water followed by an anti-bacterial solution. In the event of a soiled product, a non-abrasive cleaner is recommended in place of the warm water.
- **Do not use bleach or agents containing bleach.**
- Towel dry after use. Any materials should be disposable and dealt with in an environmentally-friendly manner.
- Keep moving parts free from limescale, soap, hairs and fibres.



### 4.3 DECONTAMINATION:

To avoid cross-contamination in an institutional setting, a three-tiered cleaning approach is recommended: warm, non-abrasive cleaner and anti-bacterial solution.

Please be aware of any infection control policies that may in force locally or appropriate to multi-user scenarios.



### FURTHER INFORMATION:

Available to download from our website

- Returns & Repair Procedure



## 5. GETTING TO KNOW YOUR PRODUCT

### 5.1 THE TILT-IN-SPACE SHOWER CHAIR & CRADLE (APPLIES TO ALL MODELS AND SIZES)

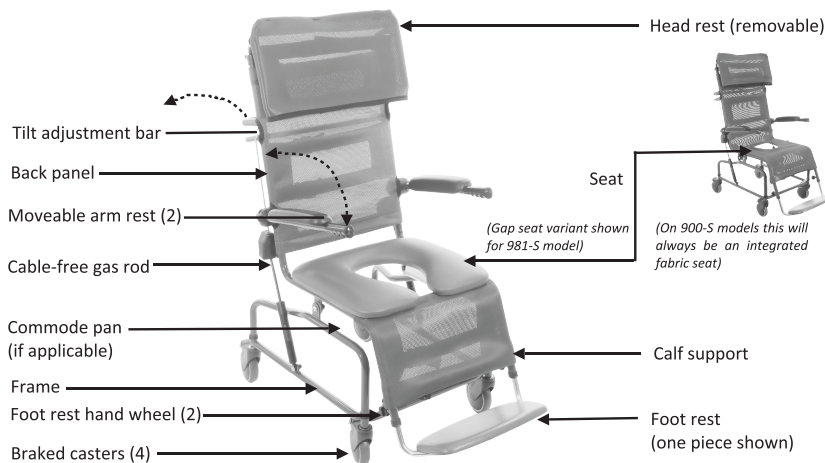

#### REAR OF FABRIC VIEW

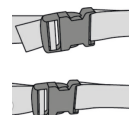

### 5.2 PRODUCT LABELS EXPLAINED

There are two types of labels associated with each bathing product.

i) Located on the main frame (example label):

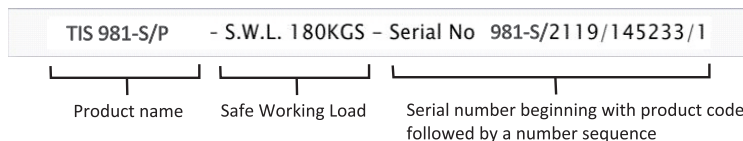

i) Located on the fabric parts (example label):

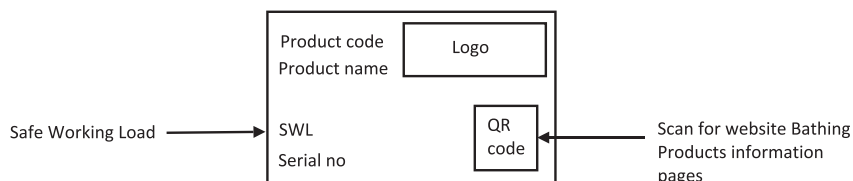

## 6. OPERATIONAL INSTRUCTIONS

Before starting, check that the bathing equipment is in safe and clean condition and is the appropriate size and model for the person to be serviced. There are a variety of ways to use and adjust this equipment, so please read carefully.

### 6.1. HEADREST

The headrest should be adjusted to suit the service user.

#### 6.1.1 Headrest Fitting

- Slide headrest fabric over the main frame
- Secure with hook and loop fastening

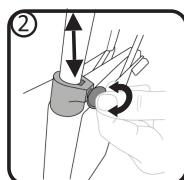
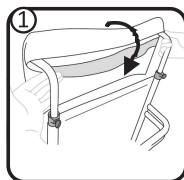

#### 6.1.2 Height Adjustment

- Release the finger screws at the top of the backrest and insert the headrest down-tubes.
- Select the desired headrest height by sliding the headrest assembly up or down.
- Secure the finger screws.

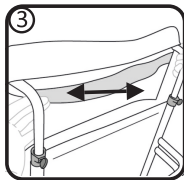

#### 6.1.3 Headrest Tension

Tension can be easily applied or released by either tightening or loosening the hook and loop attachment as required.

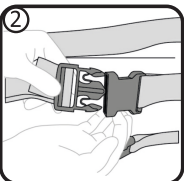
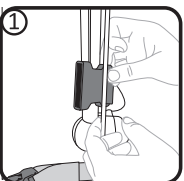

### 6.2 BACKREST

The backrest is not permanently fixed to the main frame of the chair.

#### 6.2.1 To Fit the Backrest:

- Slide the fabric backrest around the frame.
- Secure all of the plastic side-pinch buckles on the straps taking care to avoid the rod mechanism.

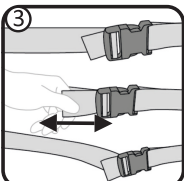

#### 6.2.2 To Remove the Backrest:

Repeat steps in 6.2.1 in reverse order.

#### 6.2.3 Backrest Tension Adjustment

Tension can be easily applied or released by either tightening or loosening the attachment strap as required.

## 6.3 ARMS

### 6.3.1 Armrests

The armrest is a self-supporting arm. The armrests must not be used to help manoeuvre the chair; push handles are supplied for this reason.

- i. To raise the arm: lift / fold upwards.
- ii. To lower the arm: pull / fold downwards.

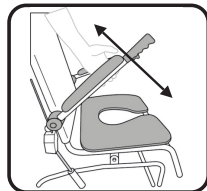

## 6.4 SEATING

**NOTE:** Seats are fitted at factory. Please contact Care & Independence for assistance with replacement seats.

- **981-S Chair model:** choice of four\* seating options, each secured with four bolts to the seat underside.  
\*(1) Full [solid] - (2) Flexi [2 split halves] - (3) Aperture [hole] - (4) Gap [Horseshoe-shaped] - can be front or rear facing
- **900-S Cradle model:** choice of two\* seating options. These are made of fabric and integral to fabric fitting.  
\*(1) Full [solid] - (2) Aperture [hole]

### 6.4.1 Removal and Fitting (981-S Flexi seat variant only)

- The rubber-moulded Flexi-seat variant prevents water ingress, minimising cross-contamination risks.
- It is secured by four bolts to the underside of each half.
- When removing the seat for maintenance or cleaning it is recommended to note the dimensions of the aperture and gap at the front of the chair to ensure it is re-fitted in the correct position.
- The seat is adjustable in width to allow improved posture and comfort.
- Ensure that the seat is set correctly for the Service User.
- Ensure that the gap in the “Flexi-seat” will not allow any part of the Service User’s body to become trapped.

**NOTE:** Paediatric and Infant Flexi-seats are upholstered not moulded. These are supplied factory-fitted.

- |  |   |   |
|--|---|---|
| <p>i. <u>To remove the seat:</u></p> <ol style="list-style-type: none"> <li>a) Undo the bolts.</li> <li>b) Lift off seat.</li> </ol> | <p>ii. <u>To fit the seat:</u></p> <ol style="list-style-type: none"> <li>a) Line up the seat holes with the corresponding frame holes.</li> <li>b) insert screws and tighten securely</li> </ol> | <p>iii. <u>To adjust the seat:</u></p> <ol style="list-style-type: none"> <li>a) Remove commode pan (if fitted).</li> <li>b) Gently loosen screws, allowing seat to move.</li> <li>c) Position seat as required.</li> <li>d) Tighten screws.</li> </ol> |
|--|---|---|

### 6.4.2 Removal and Fitting (900-S Cradle variants only).

All 900-S Tilt-In-Space cradle models have fabric seats with two plastic supports either side of the aperture to aid rigidity. Prior to the removal or fitting of the fabric seat, the plastic supports need to be removed from/inserted into the corresponding pockets located on the underside of the fabric seat area.

The fabric seat section is fitted to the main frame by clunk-click buckles. Follow instructions in 6.2, ensuring the buckles on the underside are also secured.

### 6.4.3 Adjusting the Seat Height

**Only adjust seat height when equipment not in use!**

- i. Remove the pin clip from the leg.
- ii. Select the desired seat height by sliding out the leg from the frame (This is a telescopic action).
- iii. Refit pin clip.
- iv. Repeat the adjustment for the other legs, ensuring all legs are adjusted equally.

NOTE: Laying equipment on its side can make the adjustment easier

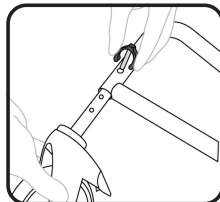

### 6.5 CALF SUPPORT

- The fabric calf support is secured to the main frame via clunk-click buckles.
- Slide fabric around the frame and secure the buckles.
- The buckles can also be used to adjust the tension by releasing or loosening the strap as required.

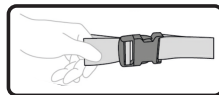
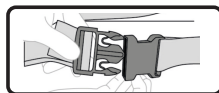

### 6.6 FOOTREST

- **DO NOT STAND ON THE FOOTREST as this may result in the chair tipping.**
- The footrest has been designed to be removed if not required.
- Both the one-piece and two-piece footrest are fitted and removed in the same way.

#### 6.6.1 Fitting

- i. Slide the footrest into the corresponding frame poles to the required position to suit user.
- ii. Secure by tightening the handwheel pin.

#### 6.6.2 Removal

- i. Undo handwheel pin
- ii. Slide footrest out.

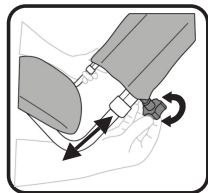

## 6.7 BRAKES

All Tilt-In-Space chair and cradle models are fitted with braked castors (identified by a red pedal). This is a foot-operated brake.

### Operation:

- Press down with the tip of the foot onto the front of the pedal to operate the brake.
- Push back on the pedal to release.

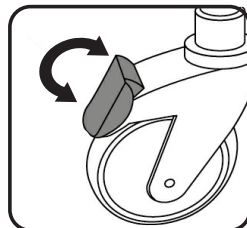

## 6.8 Tilt Recline Operation

The tilting mechanism is operated via a full width bar located below the push handle.

- Pull the release handle upwards.
- Holding the operating bar and handle, push down until the desired recline angle is achieved.
- Release the operating bar to lock position.

Reverse the previous actions to return the chair to upright position.

**NOTE:** The chair requires the service user sat in the chair to operate correctly as the tilting mechanism is pre-set to assist in returning the chair to the upright position.

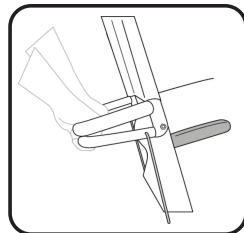

## 7. ADDITIONAL SUPPORT



SCAN QR CODE FOR;

- Product information
- User Guide



Free product training is also offered. Please contact us for further information.



- Expert advice
- Full support



- Faded label replacement
- Equipment repair

*This space has been left intentionally blank for notes*



A modern bathing choice  
for users and their carers



improving lives

# Bathing Range USER GUIDE



[www.careandindependence.com](http://www.careandindependence.com)



Care & Independence Ltd,  
Unit 3, Telford Business Centre,  
Telford Road, Bicester, OX26 4LD

033 012 80808

[sales@careandindependence.com](mailto:sales@careandindependence.com)

Monday - Friday 08.30 -17.00

*If a third party supplier has provided the product,  
you may like to write their contact details here:*



©2024 Care & Independence Ltd All Rights Reserved.  
Contents (including images) herewithin are intended as a guide and contents are infallible to error although every care and attention has been taken to ensure that the instructions represented here are honest and true. Care & Independence Ltd reserve the right to alter, modify, add or delete any of the contents and is under no obligation to notify the user of the amendments except where harm or safety issues could occur as a result. All data is correct at time of publication.