



Care Independence

Bathing Model:.....

Serial Number:

User Name:

*The bathing model and serial number
are located on the label on the frame.*

THIS USER GUIDE IS APPLICABLE
FOR THE FOLLOWING
BATHING PRODUCTS ONLY:

7710-S: Options Shower & Commode
Chair - Attendant

7700-S: Options Shower & Commode
Chair - Self Propel

7712-S: Options Shower & Commode
Chair - Transit

7715-S: Options Shower & Commode
Chair - Static

Please ensure that both the
product and any associated
accessories have been
adjusted by a competent
person prior to its initial use.

ISSUE DATE: 15/03/24
VERSION: UG/BR-OPTFAM-EN04
STATUS: APPROVED
AUTHORISED BY: Technical Director

.....
J. ASH

Bathing Range USER GUIDE

CONTENTS

1. General.....	Page 2
- Warranty	
2. Bathing Product Safety	Page 2
- General	
- Equipment Inspection	
- Equipment Servicing	
3. Damaged or Faulty Product	Page 2
4. Product Care.....	Page 2
- General	
- Cleaning	
- Decontamination	
5. Getting to Know Your Product.....	Page 3
- Options Shower & Commode Chair	
- Product Labels Explained	
6. Operational Instruction.....	Page 4-6
- Seat/Wheel height Adjustment	
- Brakes	
- Armrests	
- Backrest	
- Footrests	
7. Accessories.....	Page 6
8. Additional Support	Page 6

Thank you for choosing a Care & Independence BATHING RANGE product.

We trust both you and the end-user will find the product easy and comfortable to use throughout its lifetime.

In the event that you are dissatisfied with product performance or have any queries relating to the product usage that are not addressed in this User Guide, please contact Care & Independence.

Care & Independence Ltd is a UK manufacturer registered with MHRA as a Class 1 Medical Device Manufacturer and this is a Class 1 medical device as defined in the Medical Device Regulation 2017/745.

Our devices are designed and manufactured to meet or exceed BS EN 10535:2021 for the transfer of disabled persons and are designed and manufactured by Care & Independence, a certified ISO9001:2015 organisation.

Declaration

Care & Independence Ltd, declares under its sole responsibility that the aforementioned products to which this declaration relates, and which bear the CE marking, are in conformity with the applicable requirements of EU regulation 2017/745 as transposed in the laws of the Member States.

Intended Purpose

The device is intended for use by a care giver as a mobility aid for less-abled persons when assisted-bathing needs are required.

1. GENERAL



WARRANTY:

The BATHING RANGE products covered in this User Guide have been awarded a FIFTEEN YEAR WARRANTY on frame and TWO YEAR on components. Any manufacturing defect will be rectified free of charge. Product damage through wear and tear, neglect or accidental damage is not covered by the warranty.

2. BATHING PRODUCT SAFETY



2.1 GENERAL:

- 2.1.1. Only competent persons should ever use bathing equipment.
- 2.1.2 A risk assessment **must** be completed before using the product.
- 2.1.3 It is essential that the equipment is fit for purpose; the correct size and type of product for an individual is essential to ensure the safety and comfort of the user.
- 2.1.4 Product care and inspection instructions should be followed at all times.
- 2.1.5. **No bathing equipment must ever be used for more than its rated load** (see label).
- 2.1.6 We advise that vulnerable users are not left unattended when using this equipment.
- 2.1.6 **If there is any doubt about equipment safety, remove the equipment from use until checked and authorised for use by a competent person.**
- 2.1.7 For all associated bathing accessories supplied with this product, please ensure these items have been adjusted accordingly by a competent and trained person authorised to do so. Failure to do so may minimise support, comfort and could result in injury. please refer to the specific user guide instructions. If you require further information please contact Care & Independence.



2.2 EQUIPMENT INSPECTION:

Care & Independence recommend pre-use equipment checks by a competent person to ensure the equipment is free from defects.



2.3 EQUIPMENT SERVICING:

An annual servicing of the equipment is recommended.

3. DAMAGED OR FAULTY PRODUCT



Care & Independence have a strict *Returns & Repair Procedure* to ensure the safety of all involved.

Please **do not** send products back without completing the Return/Repair form.

4. PRODUCT CARE



4.1 GENERAL CARE:

Discolouration to some materials or fading labels may occur as a result of use over time.

NOTE: It is a recommended that the product label remain legible throughout the product's working lifetime but is not currently a statutory requirement.



4.2 CLEANING THE EQUIPMENT:

- After use, the product should be cleaned with particular attention being paid to the equipment bed base area.
- It is recommended to use clean warm water followed by an anti-bacterial solution. In the event of a soiled product, a non-abrasive cleaner is recommended in place of the warm water.
- **Do not use bleach or agents containing bleach.**
- Towel dry after use. Any materials should be disposable and dealt with in an environmentally-friendly manner.
- Keep moving parts free from limescale, soap, hairs and fibres.



4.3 DECONTAMINATION:

To avoid cross-contamination in an institutional setting, a three-tiered cleaning approach is recommended: warm, non-abrasive cleaner and anti-bacterial solution.

Please be aware of any infection control policies that may in force locally or appropriate to multi-user scenarios.



FURTHER INFORMATION:

- Available to download from our website
- Returns & Repair Procedure

5. GETTING TO KNOW YOUR PRODUCT

5.1 THE OPTIONS SHOWER & COMMODE CHAIR (APPLIES TO ALL MODELS AND SIZES)

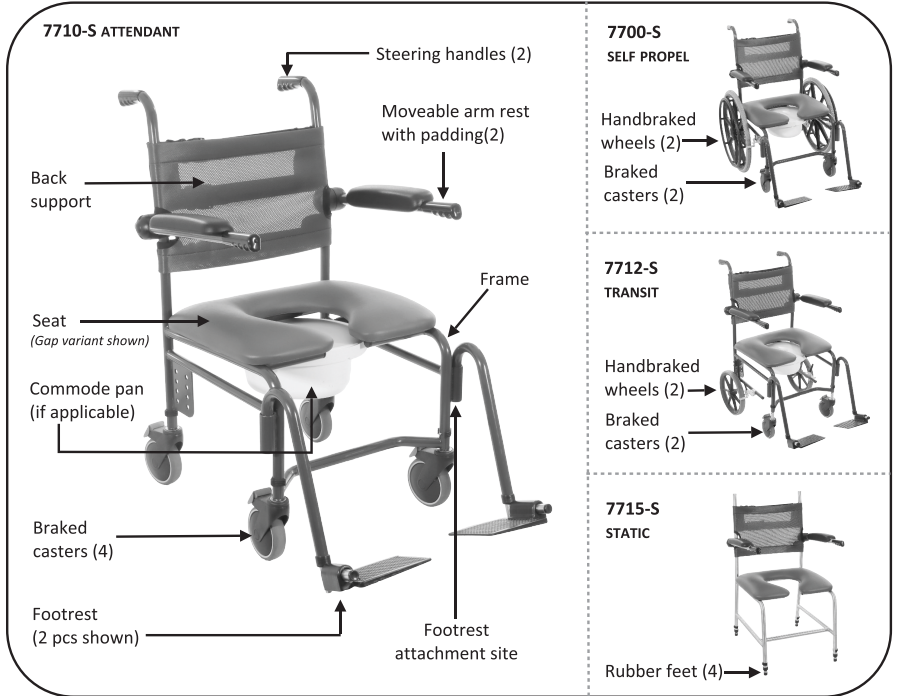

5.2 PRODUCT LABELS EXPLAINED

There are two types of labels associated with each bathing product.

i) Located on the main frame (*example label*):



i) Located on the fabric parts (*example label*):

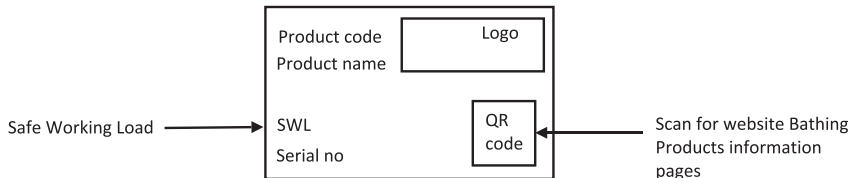

6. OPERATIONAL INSTRUCTIONS

Before starting, check that the bathing equipment is in safe and clean condition and is the appropriate size and model for the person to be serviced. There are a variety of ways to use and adjust this equipment, so please read carefully. **NOTE: Adjustments should only be undertaken by competent persons.**

6.1 SEAT/WHEEL HEIGHT ADJUSTMENT

Height adjustment can only be achieved when the chair is not in use.

6.1.1 Attendant style model 7710 only

- i. Remove the pin clip from the leg.
- ii. Select the desired seat height by sliding out the leg from the frame (This is a telescopic action).
- iii. Refit pin clip.
- iv. Repeat the adjustment for the other legs.
- v. Ensure all legs are adjusted equally.

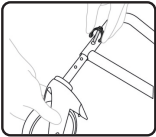

6.1.2 Self Propel style model 7700 only

There are two types of self propel wheels:

A) Metal plate or B) Black plastic moulded. Please refer to the appropriate following instructions.

NOTE: Brake adjustment is required following BOTH A & B of wheel adjustments. See 6.2.2 -B

A) To adjust height, position or change METAL PLATE self-propelling wheels

REQUIRED: 19mm spanner, socket and ratchet, allen key (not supplied).

- i. Remove the covers from the axle bolts and wheel centre.
- ii. Remove the locking nut & washer from the axle bolt.
- iii. Select the position for the wheel and insert the axle bolt through the mounting plate.
- iv. Re-fit the washer and locking nut (locking nut should be replaced by a new nut).
- v. Repeat the processes for the opposite wheel, ensuring that the axle bolt is positioned in the same hole on the mounting plate.

- vi. Adjust front castors height to match the rear wheels. See 6.1.1. Instructions.

B) To adjust height, position or change BLACK PLASTIC MOULDING self-propelling wheels

REQUIRED: 19mm spanner, socket and ratchet, 13mm spanner, 6mm Allen Key / wrench (not supplied).

- i. Remove the covers from the axle bolts and wheel centre.
- ii. Remove the locking nut & washer from the axle bolt.
- iii. Remove the wheel from the bracket.
- iv. Remove the three covers from the securing bolts through the black moulded bracket.
- v. Remove the locking nut and washer.
- vi. Remove the black brackets.
(The black bracket is located by a metal pin through the frame, this aligns with a series of holes on the inside of the bracket, the holes are 25mm apart).
- vii. Select the required hole position, align the pin with the corresponding holes and press the two black brackets together, ensuring the holes align.
- viii. Re-fit the three bolts through the brackets and secure with the locking / nyloc nut.
- ix. Re-fit the wheel, washer and locking nut (locking nut should be replaced by a new nut).
- x. Repeat the processes for the opposite wheel, ensuring that the axle bolt is positioned in the same hole on the mounting plate.
- xi. Adjust front castors height to match the rear wheels. See 6.1.1. Instructions.

6.1.3 Transit Style model 7702 only

To adjust height, position or change transit wheels.

REQUIRED: 19mm spanner, socket and ratchet, allen key (not supplied).

- i. Remove the covers from the axle bolts and wheel centre.
- ii. Remove the locking nut & washer from the axle bolt.
- iii. Select the position for the wheel and insert the axle bolt through the mounting plate.

- iv. Re-fit the washer and locking nut (locking nut should be replaced by a new nut).
- v. Repeat the processes for the opposite wheel, ensuring that the axle bolt is positioned in the same hole on the mounting plate.
- vi. Adjust front castors height to match the rear wheels. See 6.1.1. Instructions.

NOTE: Brake adjustment is required following wheel adjustments. See 6.2.2 -B for instructions.

6.2 BRAKES

6.2.1 Castor Wheels

Attendant and transit models are fitted with braked castors (identified by a red pedal). This is a foot-operated brake.

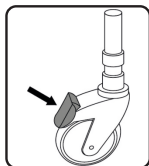

Operation:

- i. Press down with the toe of the foot onto the front of the pedal to operate the brake.
- ii. Push back on the pedal to release.

6.2.2 Handbraked wheels

A) Operation

Self propel and transit models are fitted with two handbraked wheels. These require manual operation.

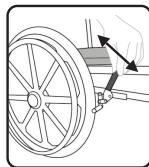

To operate the brake: push forward on the brake lever until it locks in place

To release the brake: pull back on the brake lever.

B). Handbraked wheel adjustment (applies to 7700 & 7712 models only)

After completing wheel adjustments (see 6.1.2 and 6.1.3), the brakes also require adjustment.

REQUIRED: Suitably sized allen key wrench (not supplied).

- i. Release the Allen key bolt on the brake-mounting block.
- ii. With the brake in the fully released position

slide the brake to the required position (leaving a gap of approx. 15mm between the brake and the tyre).

- iii. Re-tighten the Allen key bolt.
- iv. Repeat for the opposite wheel.

6.3 ARMRESTS

The armrest is a self-supporting arm. The armrests must not be used to help manoeuvre the chair, push handles are supplied for this reason.



To raise the arm:
lift / fold upwards.

To lower the arm:
pull / fold downwards.

6.4 BACKREST

The backrest is not fixed to the main frame of the chair.

6.4.1 To remove / fit the backrest:

- i. Wrap the backrest around the chair framework.
- ii. Secure clunk-click buckles.

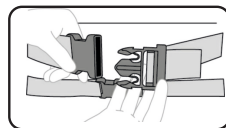

6.4.2 Tension Adjustment

The tension of the backrest can be adjusted to suit the individual user by simply loosening or tightening the back straps as required.

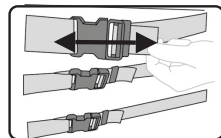

6.5 FOOTREST

Footrests are available as either 2-piece or 1-piece.

Do not stand on the footrests as this may result in the chair tipping.

2-piece footrests have been designed to be removed or folded away to ease access to and from the chair.

6.5.1 Fit & Removal

A) 2 piece footrest only

- i. To fit: Line up footrest tube and slide down into corresponding frame tube hollow.
- ii. To remove: Lift upwards and slide out of frame tube.
- iii. To lock: The footrest is locked in place by a V-groove and a plastic clip.

B) 1-piece footrest only

- i. To fit: Undo the handwheels. Line up footrest tubes and slide into corresponding frame tube hollows to desired position. Tighten handwheels to secure footrest in place.
- ii. To remove: Undo the handwheels. Slide footrest out from frame tube. Tighten handwheels.

6.5.2 Fold up (2 piece footrest only)

The footrest pads may be folded up when not in use to help prevent snagging and injury during transfer.

Simply fold footpad into a vertical position and unfold into a horizontal position when ready to use again.

7. ACCESSORIES

Where any accessories have been ordered, they will be dispatched with the chair and when appropriate, already fitted into place for your convenience.

A separate User Guide will accompany accessories.

8. ADDITIONAL SUPPORT



SCAN QR CODE FOR;

- Product information
- User Guide



Free product training is also offered. Please contact us for further information.



- Expert advice
- Full support



- Faded label replacement
- Chair repair

Bathing Range USER GUIDE

Care 
Independence

www.careandindependence.com



Care & Independence Ltd,
Unit 3, Telford Business Centre,
Telford Road, Bicester, OX26 4LD

033 012 80808

sales@careandindependence.com

Monday - Friday 08.30 -17.00

*If a third party supplier has provided the product,
you may like to write their contact details here:*



©2024 Care & Independence Ltd All Rights Reserved.
Contents (including images) herewithin are intended as a guide and contents are infallible to error although every care and attention has been taken to ensure that the instructions represented here are honest and true. Care & Independence Ltd reserve the right to alter, modify, add or delete any of the contents and is under no obligation to notify the user of the amendments except where harm or safety issues could occur as a result. All data is correct at time of publication.