



Care Independence

Bathing Model:.....

Serial Number:

User Name:

*The bathing model and serial number
are located on the label on the frame.*

THIS USER GUIDE IS APPLICABLE
FOR THE FOLLOWING
BATHING PRODUCTS ONLY:

SFS: Fixed Height Shower & Changing
Stretcher

Please ensure that both the
product and any associated
accessories have been
adjusted by a competent
person prior to its initial use.



ISSUE DATE: 15/03/24
VERSION: UG/BR-SFS-EN04
STATUS: APPROVED
AUTHORISED BY: Technical Director

.....
J. ASH

Bathing Range USER GUIDE

CONTENTS

1. **General** Page 2
 - Warranty
2. **Bathing Product Safety** Page 2
 - General
 - Equipment Inspection
 - Equipment Servicing
3. **Damaged or Faulty Product** Page 2
4. **Product Care** Page 2
 - General
 - Cleaning
 - Decontamination
5. **Getting to Know Your Product** Page 3
 - Fixed Height Shower & Changing Stretcher
 - Product Labels Explained
6. **Installation Instruction** Page 3
7. **Operational Instruction** Page 4
 - Wall Attachment
 - Using the Product

Thank you for choosing a Care & Independence BATHING RANGE product.

We trust both you and the end-user will find the product easy and comfortable to use throughout its lifetime.

In the event that you are dissatisfied with product performance or have any queries relating to the product usage that are not addressed in this User Guide, please contact Care & Independence.

Care & Independence Ltd is a UK manufacturer registered with MHRA as a Class 1 Medical Device Manufacturer and this is a Class 1 medical device as defined in the Medical Device Regulation 2017/745.

Our devices are designed and manufactured to meet or exceed BS EN 10535:2021 for the transfer of disabled persons and are designed and manufactured by Care & Independence, a certified ISO9001:2015 organisation.

Declaration

Care & Independence Ltd, declares under its sole responsibility that the aforementioned products to which this declaration relates, and which bear the CE marking, are in conformity with the applicable requirements of EU regulation 2017/745 as transposed in the laws of the Member States.

Intended Purpose

The device is intended for use by a care giver as a mobility aid for less-abled persons when assisted-bathing needs are required.

1. GENERAL



WARRANTY:

The BATHING RANGE products covered in this User Guide have been awarded a TWO YEAR WARRANTY. Any manufacturing defect will be rectified free of charge. Product damage through wear and tear, neglect or accidental damage is not covered by the warranty.

2. BATHING PRODUCT SAFETY



2.1 GENERAL:

- 2.1.1. Only competent persons should ever use bathing equipment.
- 2.1.2 A risk assessment **must** be completed before using the product.
- 2.1.3 It is essential that the equipment is fit for purpose; the correct size and type of product for an individual is essential to ensure the safety and comfort of the user.
- 2.1.4 Product care and inspection instructions should be followed at all times.
- 2.1.5. **No bathing equipment must ever be used for more than its rated load** (see label).
- 2.1.6 We advise that vulnerable users are not left unattended when using this equipment.
- 2.1.6 **If there is any doubt about equipment safety, remove the equipment from use until checked and authorised for use by a competent person.**
- 2.1.7 For all associated bathing accessories supplied with this product, please ensure these items have been adjusted accordingly by a competent and trained person authorised to do so. Failure to do so may minimise support, comfort and could result in injury. please refer to the specific user guide instructions. If you require further information please contact Care & Independence.



2.2 EQUIPMENT INSPECTION:

Care & Independence recommend pre-use equipment checks by a competent person to ensure the equipment is free from defects.



2.3 EQUIPMENT SERVICING:

An annual servicing of the equipment is recommended.

3. DAMAGED OR FAULTY PRODUCT



Care & Independence have a strict *Returns & Repair Procedure* to ensure the safety of all involved.

Please **do not** send products back without completing the Return/Repair form.

4. PRODUCT CARE



4.1 GENERAL CARE:

Discolouration to some materials or fading labels may occur as a result of use over time.

NOTE: It is a recommended that the product label remain legible throughout the product's working lifetime but is not currently a statutory requirement.



4.2 CLEANING THE EQUIPMENT:

- After use, the product should be cleaned with particular attention being paid to the equipment bed base area.
- It is recommended to use clean warm water followed by an anti-bacterial solution. In the event of a soiled product, a non-abrasive cleaner is recommended in place of the warm water.
- **Do not use bleach or agents containing bleach.**
- Towel dry after use. Any materials should be disposable and dealt with in an environmentally-friendly manner.
- Keep moving parts free from limescale, soap, hairs and fibres.



4.3 DECONTAMINATION:

To avoid cross-contamination in an institutional setting, a three-tiered cleaning approach is recommended: warm, non-abrasive cleaner and anti-bacterial solution.

Please be aware of any infection control policies that may in force locally or appropriate to multi-user scenarios.



FURTHER INFORMATION:

Available to download from our website

- Returns & Repair Procedure

5. GETTING TO KNOW YOUR PRODUCT

5.1 THE FIXED HEIGHT SHOWER & CHANGING STRETCHER

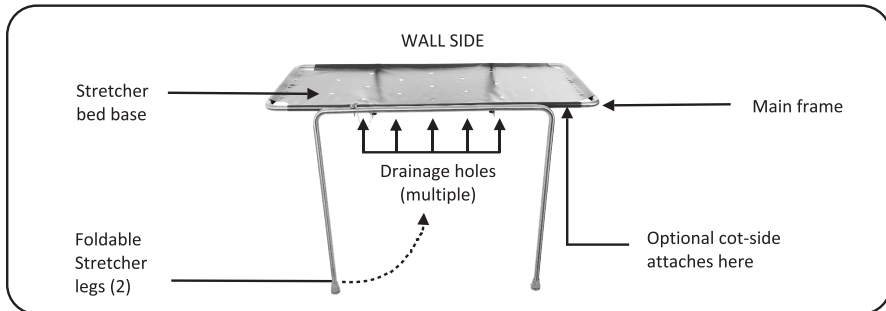

5.2 PRODUCT LABELS EXPLAINED

There is one label associated with each bathing product. It is located on the main frame.

Example label:

FH STRETCHER - S.W.L. 180KGS - Serial No SFS/ 2119/145233/1		
└───┬───┘	└───┬───┘	└───┬───┘
Product name	Safe Working Load	Serial number beginning with product code followed by a number sequence

6. INSTALLATION INSTRUCTIONS

REQUIRED:

- Expansion bolts or chemical fixings, plugs & woodscrews, spirit level, drill, pencil.

NOTE:

- 1) Before installing, ensure chosen wall is strong enough to withstand the load of the stretcher.
- 2) No fixings are supplied.
- 3) Ensure fixings are appropriate to wall construction.
- 4) Fixings must remain secure for the lifetime of the product.

i. Using a spirit level, mark a line on the wall at 900mm from floor level.

NOTE: If a lower height is required, the frame legs may be shortened with careful use of a hacksaw. Both legs **must** remain equal in length.

- ii. Offer up the stretcher to the wall with the fixing brackets already attached. Mark the position of all four holes.
- iii. Use correct-sized drill to make holes in wall.
- iv. Remove brackets from stretcher and fix to wall appropriately.
- v. Refit stretcher to brackets.
- vi. Find best position on wall for the locking latch and fix latch to all using plugs and woodscrews.
- vii. Ensure equipment is securely fixed and safe to use.

7. OPERATIONAL INSTRUCTIONS

Before starting, check that the bathing equipment is in safe and clean condition and is the appropriate size and model for the person to be serviced. There are a variety of ways to use and adjust this equipment, so please read carefully.

7.1 WALL ATTACHMENT

The Stretcher should be secured in a vertical position when not in use.

7.1.1. TO ATTACH THE STRETCHER TO THE WALL:

- i. Lift main frame into vertical position
- ii. Fold the legs underneath the main frame
- iii. Lock the main frame to the wall using the latch.

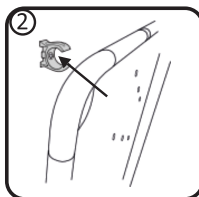
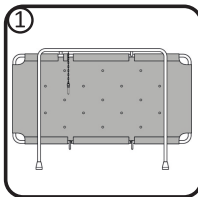

7.1.2 TO RELEASE THE STRETCHER FOR USE:

- i. Unhook the latch
- ii. Gently lower main frame
- iii. Fold legs out to floor, ensuring both are vertical and secure.
- iv. Lock stretcher legs by inserting safety pin.

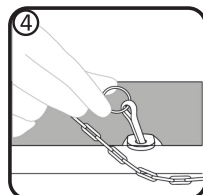
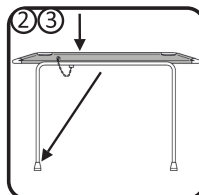
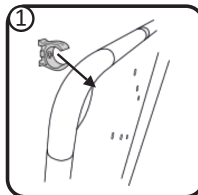

7.2 USING THE STRETCHER

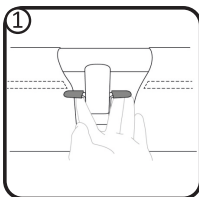

7.2.1

- i. Lower cot side (if fitted) by raising the catches simultaneously.

NOTE: Two-handed operation is a safety function as it prevents accidental dropping of the cot side.

- ii. Position user onto the equipment bed base.
- ii. Raise cot side (if fitted), ensuring 'locked' into secure position.

7.2.2

- i. Upon completion of activity, Transfer out user.

Bathing Range USER GUIDE

Care 
Independence
www.careandindependence.com



Care & Independence Ltd,
Unit 3, Telford Business Centre,
Telford Road, Bicester, OX26 4LD

033 012 80808

sales@careandindependence.com

Monday - Friday 08.30 -17.00



Product Info



SCAN QR CODE FOR;

- Product information
- User Guide



Free product training is also offered.
Please contact us for further
information.



- Expert advice
- Full support



- Faded label replacement
- Equipment repair

*If a third party supplier has provided the product,
you may like to write their contact details here:*



©2024 Care & Independence Ltd All Rights Reserved.
Contents (including images) herewithin are intended as a guide
and contents are infallible to error although every care and
attention has been taken to ensure that the instructions
represented here are honest and true. Care & Independence Ltd
reserve the right to alter, modify, add or delete any of the contents
and is under no obligation to notify the user of the amendments
except where harm or safety issues could occur as a result. All
data is correct at time of publication.