



## Care & Independence

Product Code:.....

UDI-DI Number:.....

User Name: .....

*The product code and UDI-DI number  
are located on the label.*

THIS USER GUIDE IS APPLICABLE  
FOR THE FOLLOWING  
**BURNETT REMOULD®**  
**BATHING PRODUCTS ONLY:**

BS1353: Bath Pads (2 pieces)



Care & Independence is a registered manufacturer of Medical Devices (Class 1), and also Assistive Technology devices. These devices are classified as Assistive Technology devices. Care & Independence is a certified ISO9001:2015 organisation.

#### Intended Purpose

These devices are intended to help any individual with positioning support needs in sitting, laying and bathing situations.

ISSUE DATE: 15/03/24  
VERSION: UG/BRM-1353-EN02  
STATUS: APPROVED  
AUTHORISED BY: Technical Director

  
.....  
J. ASH

## 1. GENERAL



### WARRANTY:

The BURNETT REMOULD® products covered in this User Guide have been awarded a ONE YEAR WARRANTY. Any manufacturing defect will be rectified free of charge. Product damage through wear and tear, neglect or accidental damage is not covered by the warranty.

## 2. PRODUCT SAFETY



### 2.1 GENERAL:

- 2.1.1. Only competent persons should ever use these devices.
- 2.1.2 A competent person should assess the use of the product prior to use.
- 2.1.3 It is essential that the equipment is fit for purpose; the correct size and type of product for an individual is essential to ensure the safety and comfort of the user.
- 2.1.4 Product care and inspection instructions should be followed at all times.
- 2.1.5. We advise that vulnerable users are not left unattended when using this equipment.
- 2.1.7 **If there is any doubt about equipment safety, remove the equipment from use until checked and authorised for use by a competent person.**

### 2.2 EQUIPMENT INSPECTION:

- 2.2.1 Care & Independence recommend pre-use equipment checks by a competent person to ensure the equipment is free from defects.
- 2.2.1 Regularly:
  - i. Wash as per instructions. This will ensure the product is kept fresh and hygienic.
  - ii. Check suction cups for wear and tear. Contact Care & Independence for replacement suction cups if required.
- 2.2.3 Quarterly: Check any valves for wear around seal plunger. Contact Care & Independence should a replacement valve be necessary.
- 2.2.4 Every 6 months: Check pump.
  - i. Ensure tube is not split.
  - ii. Hook and nozzle are still integral and operational.
  - iii. Air evacuates correctly.



- 2.2.5 Bi-Annually: Check seams for wear and tear. Contact Care & Independence in the event of any deterioration.

## 3. DAMAGED OR FAULTY PRODUCT



Care & Independence have a strict *Returns & Repair Procedure* to ensure the safety of all involved.

Please **do not** send products back without completing the Return/Repair form.

## 4. PRODUCT CARE



### 4.1 GENERAL CARE:

- 4.1.1 Discolouration to some materials or fading labels may occur as a result of use over time.

NOTE: It is a recommended that the product label remain legible throughout the product's working lifetime but is not currently a statutory requirement.
- 4.1.2 To avoid piercing the appliance, do not use around sharp objects.

### 4.2 ADDITIONAL PRODUCT CARE FOR BATHING ENVIRONMENT

- 4.2.1 Ensure surfaces are free of all deposits of oils, soaps and any powders left by cream mousses or cleaners.
- 4.2.2 Ensure bath surface is free from any limescale deposits. Clean the surface if feeling dull or rough to touch.
- 4.2.3 Bath water should be a mix of hot and cold. Do not fill with hot water only as this will distort the casing and suction cups.



### 4.3 CLEANING THE PRODUCT:

- 4.3.1 After use, the product should be cleaned with particular attention being paid to any crevices plus seams and suction cups to remove any deposits.
- 4.3.2 It is recommended to use clean warm water with diluted detergent. Diluted disinfectants may also be used for hygiene.

#### 4.3.3 Do not use bleach or agents containing bleach.

#### 4.3.4 Towel dry after use.

#### 4.3.5 Keep product and bath surface free from limescale, soap, hairs and fibres.

#### 4.3.6 Hard water areas; we advise removing suction cups from the press studs and soaking in a diluted de-scaling solution to remove any deposits. We recommend this is conducted with a monthly frequency.

#### 4.5 DECONTAMINATION:

To avoid cross-contamination in an institutional setting, a three-tiered cleaning approach is recommended: warm, non-abrasive cleaner and anti-bacterial solution.

Please be aware of any infection control policies that may in force locally or appropriate to multi-user scenarios.



#### FURTHER INFORMATION:

Available to download from our website

- Returns & Repair Procedure
- Full product specifications
- Copy of this User Guide

## 5. GETTING TO KNOW YOUR PRODUCT

### 5.1 BATH PADS

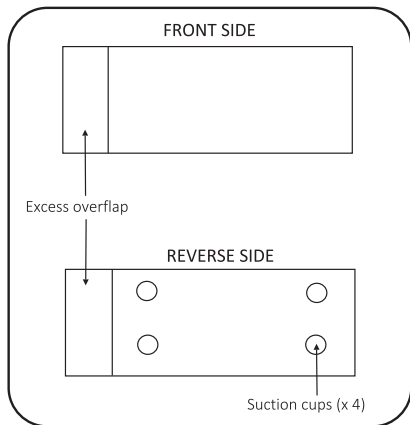

### 5.2 PRODUCT LABELS EXPLAINED

There is one label associated with each BURNETT REMOULD® product. The UDI-DI number is a unique identification number for the product line - it is not to be confused with an individual serial number. BURNETT REMOULD® products are not issued with serial numbers.

Example label:

LOGO	MANUFACTURER INFO		
FIRE SAFETY INFO			
PRODUCT INFO: SKU,UDI-DI NO, DATE OF MANUFACTURE		QR CODE	CERTIFICATION MARKS
CERTIFICATION MARKS			

## 6. OPERATIONAL INSTRUCTIONS

Before starting, check that the equipment is in safe and clean condition and is the appropriate size and model for the person to be serviced. There are a variety of ways to use and adjust this equipment, so please read carefully.

**This product is supplied ready to use. There is no prior preparatory work required.**

### 6.1 To Attach Pad To Surface

- Position pad where required with suction cups against structure surface e.g. Bath side.
- Press firmly on suction cups to secure to surface.
- Repeat for additional pad(s).

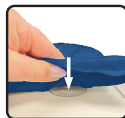

#### NOTE:

- Ensure all suction cups are stuck to the surface before introducing any water.
- We recommend the excess overlap being positioned away from user body or at the bottom if being used vertically.

### 6.2 To Remove Pad From Surface

- Break the seal at point of contact with bath surface. This will release the pressure and allow the suction cup to unstick from the surface.
- Repeat for additional cups and pads.



NOTE: Do NOT rip suction cups away from surface as this will cause stress to the pouch at point of attachment and may result in a weakened join over

# BURNETT Re.Mould® USER GUIDE



SCAN QR CODE FOR;

- Product information
- User Guide



Free product training is also offered.  
Please contact us for further  
information.



- Expert advice
- Full support

Care   
Independence

[www.careandindependence.com](http://www.careandindependence.com)



Care & Independence Ltd,  
Unit 3, Telford Business Centre,  
Telford Road, Bicester, OX26 4LD

033 012 80808

[sales@careandindependence.com](mailto:sales@careandindependence.com)

Monday - Friday 08.30 -17.00

*If a third party supplier has provided the BURNETT  
REMOULD® product, you may like to write their  
contact details here:*



©2024 Care & Independence Ltd All Rights Reserved.  
Contents (including images) herewithin are intended as a guide  
and contents are infallible to error although every care and  
attention has been taken to ensure that the instructions  
represented here are honest and true. Care & Independence Ltd  
reserve the right to alter, modify, add or delete any of the contents  
and is under no obligation to notify the user of the amendments  
except where harm or safety issues could occur as a result. All  
data is correct at time of publication.